

VILLA MEDITERRANEO

SANTA POLA

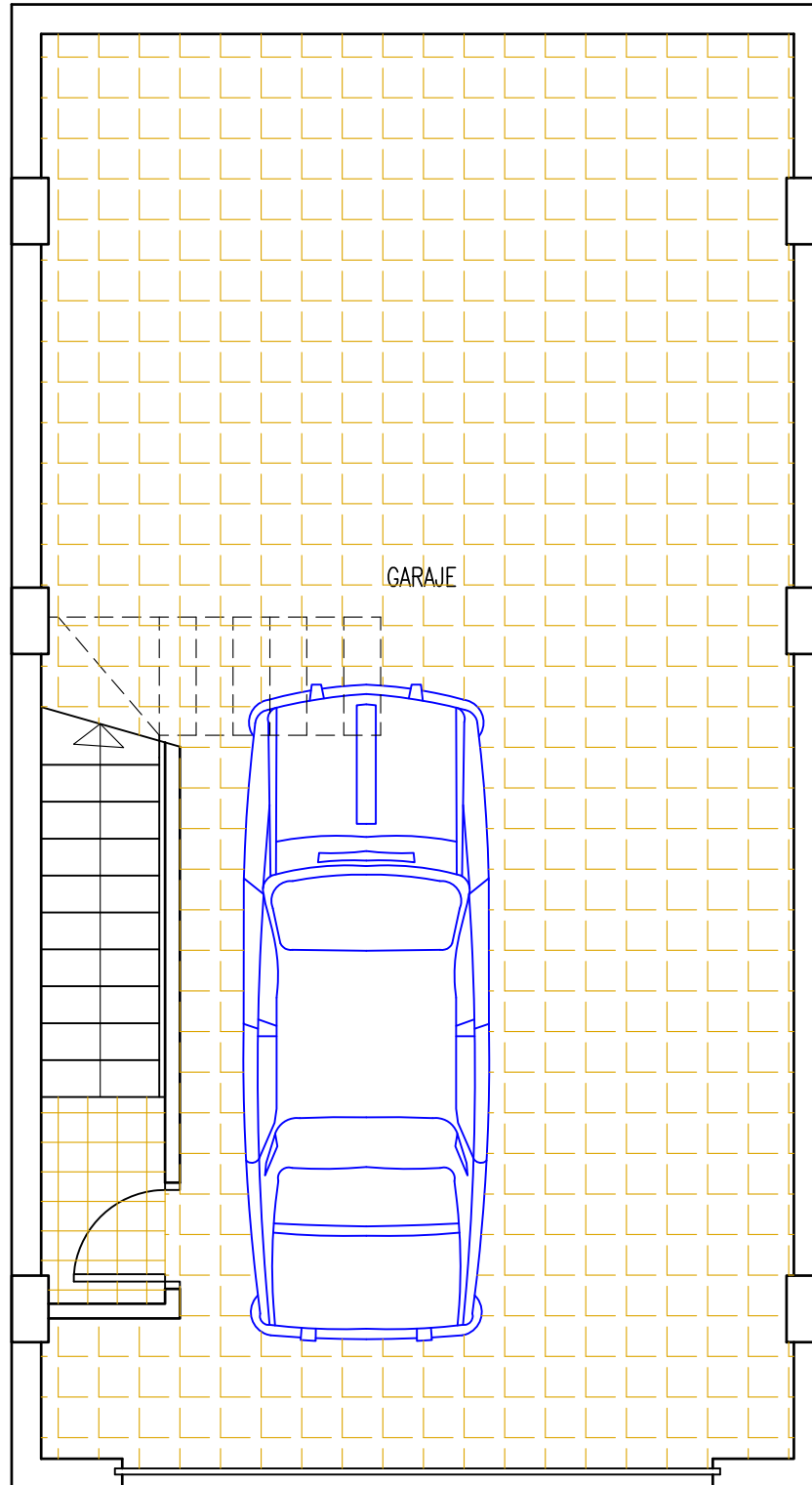

SUPERFICIE UTIL

GARAJE _____ 48.71 m²

P/P _____ 24.29 m²

TOTAL _____ 73.00 m²

SUPERFICIE CONSTRUIDA
INCLUIDO P/P

GARAJE _____ 80.16 m²

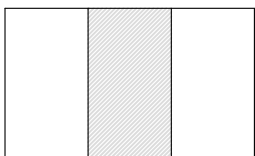

PLANTA SOTANO

VIVIENDA TIPO BG3